

[Strohm Teka Hungary](#) > [Grifos de lavabo](#) > [Washbasin mixer](#) >



FORMENTERA

Formentera mosdó csaptelep

Modern design white basin tap.

Ref: 62346120BC

Colour	White
Weight	2 kg

 2 years warranty

Description

Fehér mosdó csaptelep, amely a modern formákat tükrözi.

Technical features

- Constant optimised water consumption with real water saving system
- Saves up to 60% compared to standard single lever mixer
- 3/8" flexible inlet pipes
- Anti-escale aerator
- Without pop-up waste

Finishings and materials

- Designed for one sink washbasins

Images

Legal disclaimer:

*Certain technical factors and features of our finishes may be altered due to possible variations in the configuration of your computer and/or printer; these data are therefore only approximate and not definitive. We regularly review our product specifications to improve their characteristics and warranties. Please request detailed information from our sales department for any building or refitting projects.

Strohm Teka Hungary > Grifos de lavabo > Washbasin mixer >

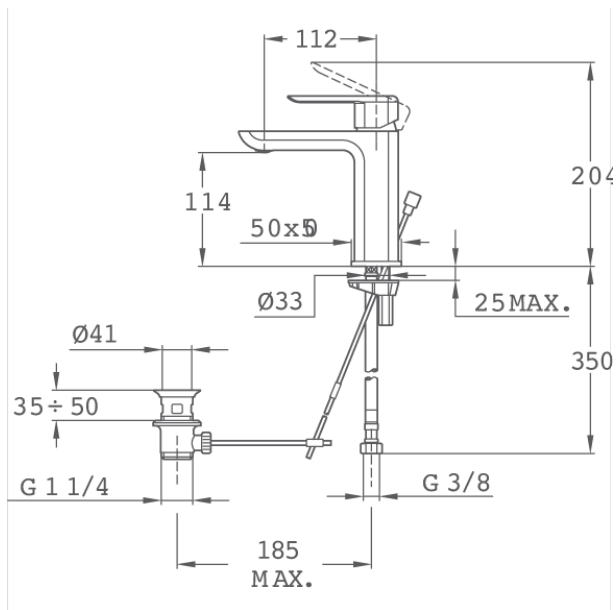

Downloads



 [User guide](#)



 Product drawings

Legal disclaimer:

*Certain technical factors and features of our finishes may be altered due to possible variations in the configuration of your computer and/or printer; these data are therefore only approximate and not definitive. We regularly review our product specifications to improve their characteristics and warranties. Please request detailed information from our sales department for any building or refitting projects.