

[Strohm Teka Hungary](#) > [Basins & bath cabinets](#) > [Basin taps](#) > [Washbasin mixer m](#) >



## SENSE

### Sense mosdó csaptelep M

Tall modern built-in tap basin tap to suit any bathroom.

Ref: 91346020N2

Colour	Brave Black
Weight	2 kg

 2 years warranty

## Description

Beépíthető mosdó csaptelep, modern kialakítással, PVD bevonatú merész fekete színnel.

## Technical features

- Anti-scale aerator with water flow limiter 5l/min
- Saves up to 60% compared to standard single lever mixer
- 3/8" and 1/2" flexible inlet pipes included
- Without pop-up waste
- PVD paint coating
- No finger print treatment

## Images

### Legal disclaimer:

\*Certain technical factors and features of our finishes may be altered due to possible variations in the configuration of your computer and/or printer; these data are therefore only approximate and not definitive. We regularly review our product specifications to improve their characteristics and warranties. Please request detailed information from our sales department for any building or refitting projects.

Strohm Teka Hungary > Basins & bath cabinets > Basin taps > Washbasin mixer m >

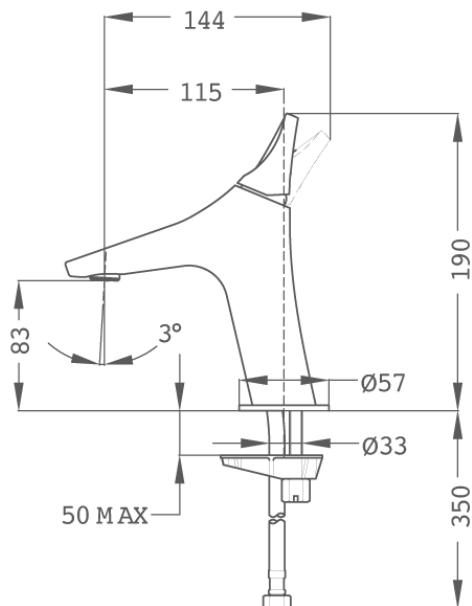

## Downloads



User guide



Product drawings

### Legal disclaimer:

\*Certain technical factors and features of our finishes may be altered due to possible variations in the configuration of your computer and/or printer; these data are therefore only approximate and not definitive. We regularly review our product specifications to improve their characteristics and warranties. Please request detailed information from our sales department for any building or refitting projects.